

High-quality physician dictation microphone with PC mouse functions.

Nuance PowerMic™ III is specially designed to enhance clinician productivity, providing ergonomic control of both standard dictation and speech recognition functions.

Nuance PowerMic III microphone offers simplified, thumb-control operation for dictating, navigating, reviewing, and editing speech recognition generated documentation.

Full Dictation Control

Nuance PowerMic III advances clinician PC dictation to a new level, making it easier and faster to control voice recording, navigate and select fields in on-screen templates and standard reports, and move through recognized text reports for review and editing. In addition to providing complete dictation control, Nuance PowerMic III incorporates full-function, Microsoft® compatible, PC mouse capabilities into the microphone to reduce the need for care givers to move between the microphone, mouse, and keyboard.

With Nuance PowerMic III, clinicians can rapidly navigate report template fields, then record and use “voice fill-in” capabilities to insert recognized text into report templates. By combining an ergonomic hand microphone with PC mouse functions, clinicians gain new levels of dictation speed, ease-of-use, and productivity.

Key Features:

- USB connectivity for easy plug-and-play installation as well as eliminating the need for sound card-enabled PCs
- Unidirectional microphone with noise-cancellation ensures higher accuracy in even the noisiest environments
- Perfect companion to PowerMic Mobile, which turns smartphones into secure wireless microphones
- Support individual clinician preferences and workflows by offering a mix of PowerMic III and PowerMic Mobile

Nuance PowerMic III Includes:

- Your choice of either a 3' or 9' USB cable to suit your workflow
- Holster

Flush, Angled Microphone Element
for user comfort and optimal recording level/signal.

Primary Dictation Controls
Record, Rewind, Play, Fast Forward, Enter/Select.

“Track-Point” and Left/Right Click “Mouse” Tool
to control the onscreen cursor, navigate and select functions.

Anti-bacterial Surface
for use in clinical settings.

Transcribe Button
to recognize speech or send dictation to a transcriptionist automatically, when clinician does not self-complete.

Tab-Forward/Tab-Backward
for speeding navigation through voice-driven templates and forms.

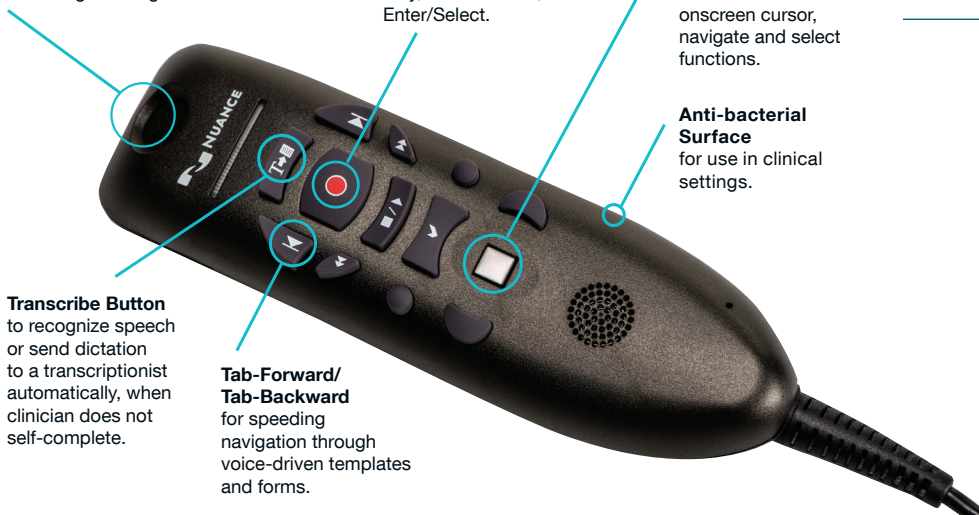

Technical specifications

Operating System: Windows® 7, Windows 8.1, Windows 10

USB: 1.1 or higher (USB port must be able to deliver min 500mA for power consumption)

Supported Environments: Citrix® and VMware are supported.
For more information, please contact Nuance Technical Support.

Frequency Response Input/Output

Microphone 20 - 16,000 Hz
Speaker 500 - 5,000 Hz

Signal-to-Noise Ratio: +70db

Power Consumption

Current: max 500mA (max playback volume)
Power: max 2.5 VA (max playback volume)
Typical current consumption:
– Standby: 115mA
– Recording (with LED on): 130mA
– Playback at max volume: 400mA
Operating Temperature 5° to 35° C (41°F to 95°)
Storage Temperature -25 to +70° C (-13°F – 158°F)

Safety

– IEC/EN/UL 60950-1: 2005 2nd edition): AM1:2009 Safety of Information Technology Equipment (ITE)
– Voltage and power draw: 5 Vdc, 500 mA max

Emissions – Class B

– EN 55032:2012 – Electromagnetic Compatibility of multimedia equipment Emissions requirements
– AS/NZS CISPR 32:2013 Electromagnetic Compatibility of multimedia equipment Emissions requirements
– FCC Title 47 of the Code of Federal Regulations (CFR47) – Telecommunications part 15.107:2015 Radio Frequency Devices
– ICE-003:2012 Information Technology Equipment (ITE) – Limits and methods of Measurement

Immunity

– EN 55024:2010 Information Technology Equipment – Immunity characteristics – Limits and methods of Measurement

FCC warning to user

– This device complies with part 15 of the FCC rules. Operation is subject to the following two conditions:
(1) This device may not cause harmful interference, and
(2) this device must accept any interference received, including interference that may cause undesired operation.

Compliance



REACH



Manufacturers declaration of conformity

The devices complies with the following EU Directives
– 2006/95/EC Low Voltage directive equipment safety,
– 2001/95/EC General Product Safety,
– 2014/30/EU Electromagnetic Compatibility,
– 2011/65/EU RoHS
– 1907/2006/EC Reach
Date of first affixing the CE mark 2015

nuance.com/healthcare

healthcare-info@nuance.com

877-805-5902

About Nuance Communications, Inc.

Nuance Communications, Inc. is a leading provider of voice and language solutions for businesses and consumers around the world. Its technologies, applications and services make the user experience more compelling by transforming the way people interact with devices and systems. Every day, millions of users and thousands of businesses experience Nuance's proven applications. For more information, please visit: www.nuance.com/healthcare. Connect with Nuance on social media through the healthcare blog, [What's next](#), as well as [Twitter](#) and [LinkedIn](#).